

100% Original

 iFace

Reflection
for Google Pixel



Official Store

Reflection Case



Hexagon Pattern
Superior protection from external impacts

3X Protection



Four corners
Air Pocket

TPU
Durable
Lightweight
Flexible



Sensible Touch Feel

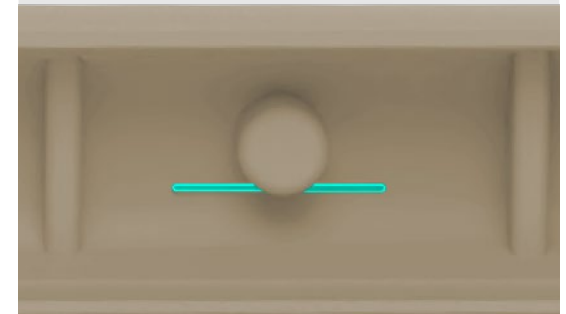

Inner rounded protrusions and integrated seams

Innovative Attention to Detail



Strap Hole

High Durability

Minimize scratches and external shocks from daily use



Shatter-Resistant

Anti-Fingerprint

Prevent Bubbles

9H

Flexible Tempered Glass

**Normal
Tempered Glass**



**iFace Reflection
with Shatter-Resistant
Treatment**



Shatter-Resistant

Special treatment minimizes shards of
glass in case of damage

No more
devastating
drops



**DROP
TESTED**

CERTIFIED

MIL-STD-810G Test

**Over 26 drops from a height of 1.22m
with no damage or abnormalities**

Screen Protection



Perfectly capturing
every detail with
unique clarity

Camera Protection



Raised Bezel



A phone as unique as you are

Create a unique look with each different color.





Black



Beige

You may also like :



First Class



Reflection Ring

How to use

How to assemble :



- 1 Please align the smart device with the top right corner of the case where the camera hole is.

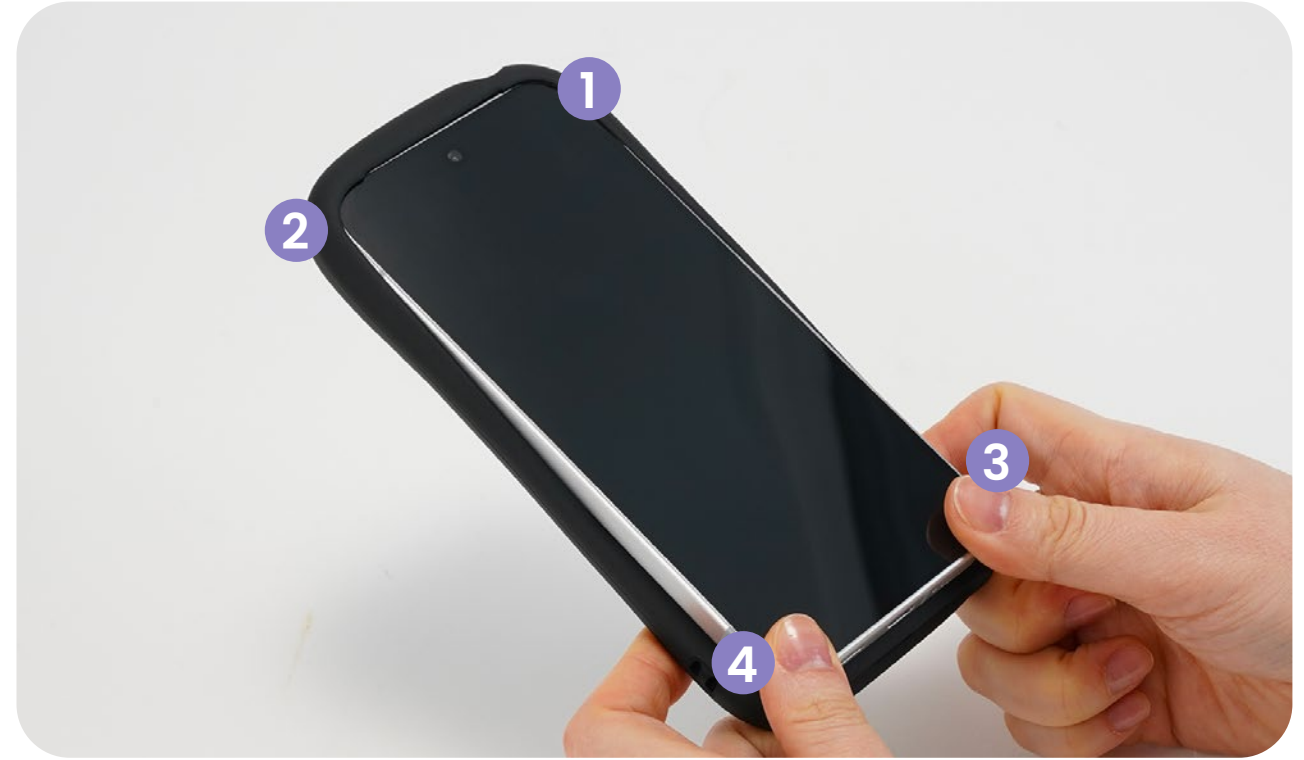

- 2 Gently press and secure each corner in order from 1 to 4.

Separation :



- 1 To remove, simultaneously press both sides from the bottom.



- 2 Safely removed!

by
your
side.

We encourage you to take the road you've never taken.
Try something you've never done before.
Explore the unknown daily with the warm feeling of being safe.
We will always protect you.
We are iFace.

Inspired &
Designed in

Seoul



 iFace

iface.com